

Contoured Perforated Front Fence and Divider System Installation Instructions

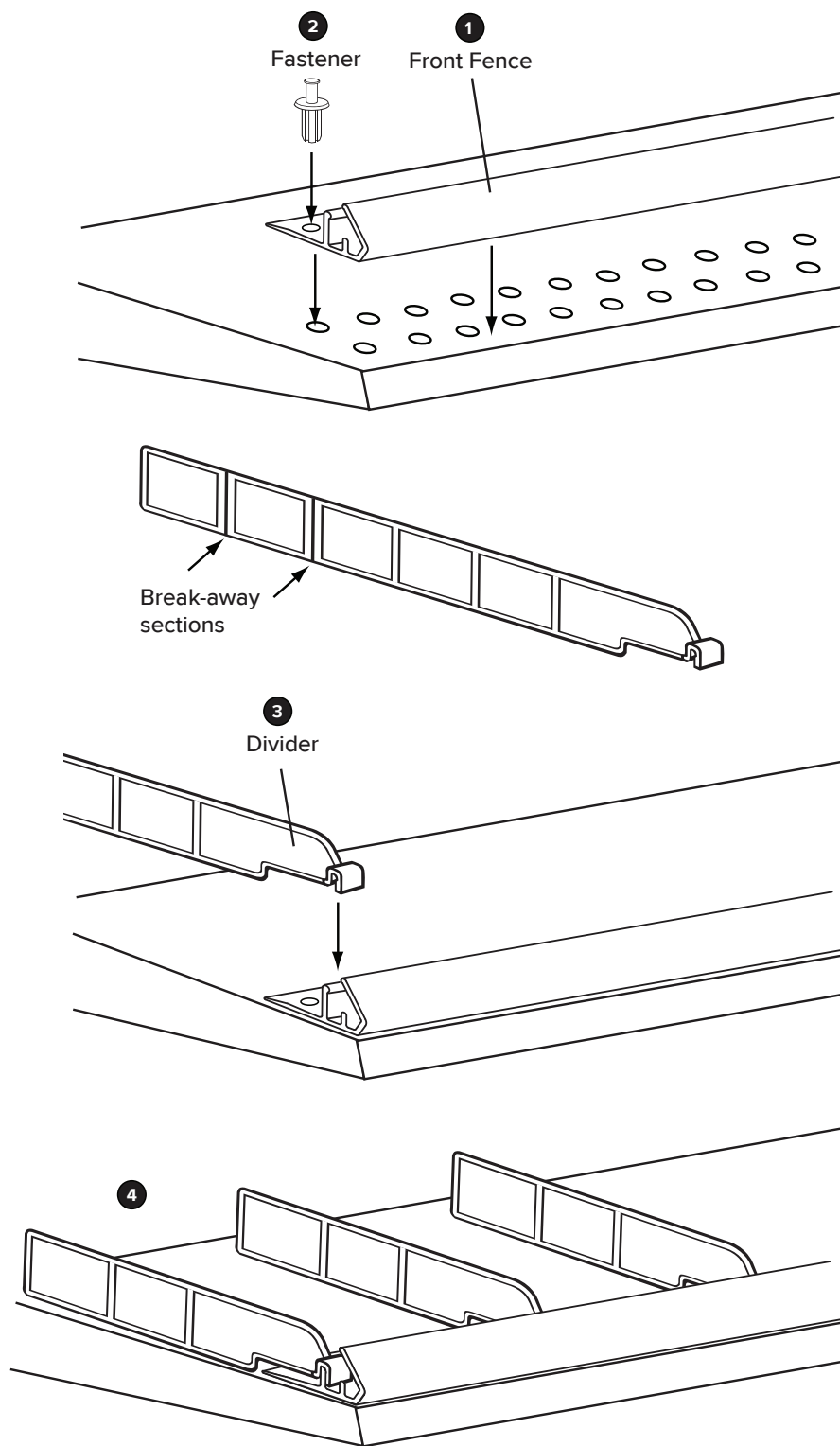

1

Set front fence on shelf.
Align holes of fence with holes
of shelf.

2

Insert fastener into holes.

3

**NOTE: If Divider extends beyond
rear edge of shelf, break off one
back section of Divider.**

Starting with the left side, insert
front clip of Divider onto back lip
of Front Fence.

4

Continue inserting Dividers from
left to right. Place product between
Dividers and adjust Dividers left
and right to fit product facings.

20190410